



PACKING	INNER	MASTER
/	pcs	pcs
Polybag	4	4



TECHNICAL DATA

Power supply	220V AC
Power supply provided	NO
Lighting source	E27 BULB
Lighting power (W)	Max 100
Light beam	DIFFUSE
Lamp included	(NOT INCLUDED)
Attachment	E27
Beam angle (°)	360°
IP Protection	IP44
Insulation class	II
Color	OPAL
Country of origin	CHINA
Material	PLASTIC - PMMA
Warranty	2 YEARS
Width (mm)	300
Depth (mm)	300
Height (mm)	320
Net weight (Kg)	0.600

DESCRIPTION

IP44 outdoor sphere, diameter 300 mm. Compatible with LED bulbs up to 100W; E27 socket; bulb not included; 360° diffusion. Material: PMMA; PMMA is a polymer that is highly resistant to both impact and the passage of time. It connects directly to the mains voltage. Velamp is an Italian company that stands behind its products: beware of imitations.

LOGISTICS DATA

Packing type	Polybag
Pack length (mm)	320
Pack width (mm)	320
Pack height (mm)	320
Packed product weight (kg)	0.610
Inner length (cm)	63
Inner height (cm)	32
Quantity in inner	4
Gross weight inner (kg)	2.410
ITF INNER	18003910106328
Quantity in master	4

LOGISTICS DATA

ITF MASTER	28003910106325
How many pieces on 80x120 pallet (pz)	40
INTRASTAT Code	94051140
DEEE	0.11
ECOLOGIC SCALES 2025	MLUMI030000
Country of origin	CHINA



Base dimensions:

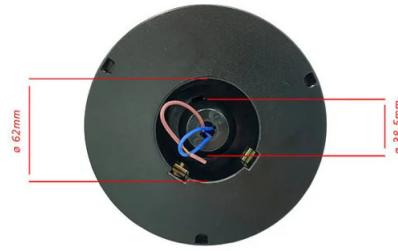

Suitable for poles \varnothing 60mm

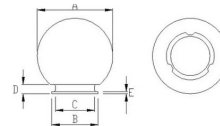

Codice Prodotto Item code Code Codigo Code	Dimensioni Dimensions / Dimensiones / Dimensions / Größe				
	A	B	C	D	E
SPH200	200 mm	95 mm	91 mm	15 mm	2 mm
SPH205	200 mm	95 mm	91 mm	15 mm	2 mm
SPH208	200 mm	95 mm	91 mm	15 mm	2 mm
SPH250	250 mm	120 mm	112 mm	13 mm	3 mm
SPH255	250 mm	120 mm	112 mm	13 mm	3 mm
SPH258	250 mm	120 mm	112 mm	13 mm	3 mm
SPH300	300 mm	140 mm	130 mm	15 mm	3 mm
SPH305	300 mm	140 mm	130 mm	15 mm	3 mm
SPH308	300 mm	140 mm	130 mm	15 mm	3 mm
SPH307	300 mm	140 mm	130 mm	15 mm	3 mm
SPH400	400 mm	150 mm	140 mm	15 mm	5 mm
SPH405	400 mm	150 mm	140 mm	15 mm	5 mm
SPH408	400 mm	150 mm	140 mm	15 mm	5 mm

1 Choose your globe diameter:

2 Choose the colour of your globe:

3 Choose installation:

on pole:
 choose the pole length: 0.8m / 1m / 1.3m / 2m / 2.4 m
 SPH142 base

If you want to install 2 globes:
 you must use the SPH183 connector 200 / 250 / 300mm
 SPH150 for globes 200 / 250 / 300mm OR SPH152 for globes 400mm

If you want to install 3 globes:
 you must use the SPH183 connector 200 / 250 / 300mm
 SPH150 for globes 200 / 250 / 300mm OR SPH152 for globes 400mm

on wall:
 SPH150 for globes 200 / 250 / 300mm OR SPH152 for globes 400mm

on stand:
 Short base: SPH140 OR Long base: SPH142

